

#### GENERAL FEATURES

- Top mount
- 22 (.6mm) gauge stainless steel
- Durable satin finish
- 6-7/16" (164mm) depth
- Overall size: 33" (838mm) x 19" (483mm)
- 3-1/2" (89mm) center drain opening
- Faucet holes (4) 1-1/2" (38mm) diameter
- Cutout dimension: 32-3/8" (822mm) x 18-3/8" (467mm) with 1-1/2" (38mm) radius corners
- Mounting hardware for countertops up to 3/4" (19mm) thick included
- Sound insulation – spray undercoating on bottom
- Minimum cabinet size: 36" (914mm)
- 25 year limited warranty
- Sink complies with ASME A112.19.3-2008 / CSA B45.4-08.

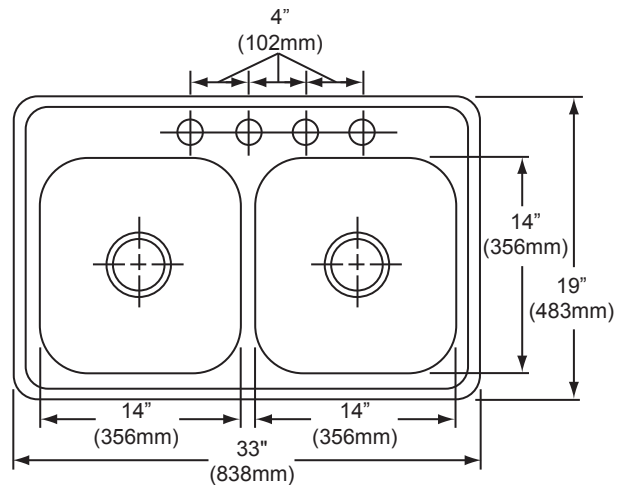

These sinks are listed by the International Association of Plumbing and Mechanical Officials as meeting the requirements of the Uniform Plumbing Code and the National Plumbing Code of Canada.

#### RECOMMENDED ACCESSORIES

Bottom Grid: GBG1414SS

Drain: D1125, LK35

Faucet Hole Cover: LK125R

