

**ELKAY®**

sinks + faucets

*Introducing*

**AVADO®**

Work Bench™ Sinks



**2009**

**AVADO®**  
Work Bench™

We are pleased to announce another innovative design from Elkay – the Avado® Work Bench™ product line, consisting of both top mount and undermount installation options. Manufactured from type 304 stainless steel with a polished satin finish, we have combined the functional features of the Work Bench partition with stainless steel's durability. The Work Bench features a wide bench that will comfortably hold a heavy stock pot filled with water, even allowing the sturdy bench to act like an extra set of hands holding it in one place while you work around it.

#### Features and Benefits

- Type 304 stainless steel with a polished satin finish that is easy to clean and offers years of dependable use
- Unique and functional Work Bench™ partition will support heavy pots and pans at a comfortable height without the worry of tipping over
- Extends the functional area of the sink without adding to the overall sink size
- Avado geometry – modern, symmetrical design
- 10" Bowl depth with zero radius corners, providing a deep and large compartment to hold practically any kitchen utensil or cookware
- Sound Guard® undercoating reduces condensation and dampens sound
- Elkay Limited Lifetime warranty for peace of mind



Discover the professional's choice.™



**EFULB361810CDBR**

Undermount

Gauge: 16  
 Finish: Polished Satin  
 Bowl Depth: 10"  
 Work Bench Height: 4"  
 Drain Opening: 3½"  
 Undercoating: Sound Guard®  
 Minimum Cabinet Size: 39"

**Optional Accessories:**

Cutting Board:  
 LKCBF1316HW (Small Bowl)  
 LKCBF1418HW (Large Bowl)

Rinsing Basket:  
 LKFRB1316SS (Small Bowl)  
 LKFRB1418SS (Large Bowl)  
 LKWUCSS Utensil Caddy

Bottom Grid:  
 LKFOBG1316SS (Small Bowl)  
 LKFOBG1418SS (Large Bowl)

Drain: LK99

Mounting Clips:  
 LKUCLIP8 (2 packages required)

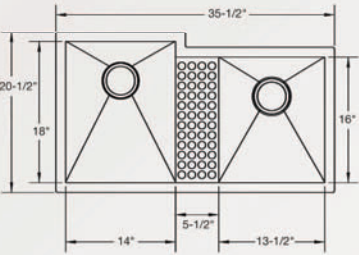

**EFTLB332210CDBL**

Top Mount

Gauge: 16  
 Finish: Polished Satin  
 Bowl Depth: 10"  
 Work Bench Height: 4"  
 Faucet Holes: 1 2 MR2 3 ④ 5  
 Drain Opening: 3½"  
 Undercoating: Sound Guard®  
 Minimum Cabinet Size: 36"

**Optional Accessories:**

Cutting Board:  
 LKCBF1116HW (Small Bowl)  
 LKCBF1316HW (Large Bowl)

Rinsing Basket:  
 LKFRB1116SS (Small Bowl)  
 LKFRB1316SS (Large Bowl)  
 LKWUCSS Utensil Caddy

Bottom Grid:  
 LKFOBG1116SS (Small Bowl)  
 LKFOBG1316SS (Large Bowl)

Drain: LK99

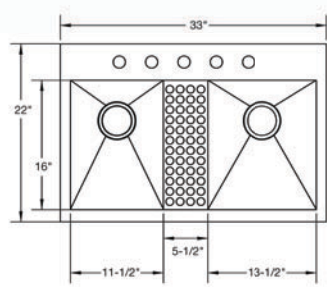

**EFULB331810CDB**

Undermount  
 Reversible design, sink can be rotated so large bowl is on the left or right

Gauge: 16  
 Finish: Polished Satin  
 Bowl Depth: 10"  
 Work Bench Height: 4"  
 Drain Opening: 3½"  
 Undercoating: Sound Guard®  
 Minimum Cabinet Size: 36"

**Optional Accessories**

Cutting Board:  
 LKCBF1116HW (Small Bowl)  
 LKCBF1316HW (Large Bowl)

Rinsing Basket:  
 LKFRB1116SS (Small Bowl)  
 LKFRB1316SS (Large Bowl)  
 LKWUCSS Utensil Caddy

Bottom Grid:  
 LKFBG1116SS (Small Bowl)  
 LKFBG1316SS (Large Bowl)

Drain: LK99

Mounting Clips:  
 LKUCLIP8 (2 packages required)

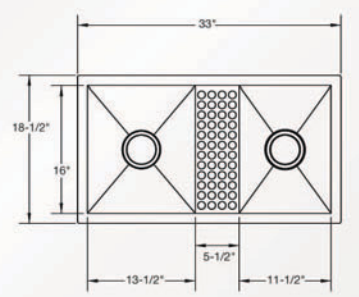

○ Indicates standard number of faucet holes

Elkay

2222 Camden Court • Oak Brook, Illinois 60523

Customer Care (630) 572-3192

elkayusa.com