



**NEW**

**EFT402211 Avado** 

Includes LKDTS1005SS drain tray for rear bowl

Gauge: 16  
 Finish: Polished satin  
 Bowl Depth: front 11"; rear 4"  
 Faucet Holes: 0 1   
 Drain Opening: 3 1/2"  
 Undercoating: Sound Guard®  
 Minimum Cabinet Size: 45"

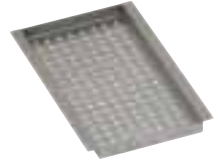

Recommended  
 Faucet: LK7228SS (shown); Drain: LK99

**Optional Accessories** (■ Front bowl)

- |  |   |  |
|--|---|--|
| Cutting Board  | Bottom Grid  | Drain Tray  |
| ■ LKCB1314HW   | ■ LKLOBG3214SS  | ■ LKDTD1314SS, LKDTL3805SS   |

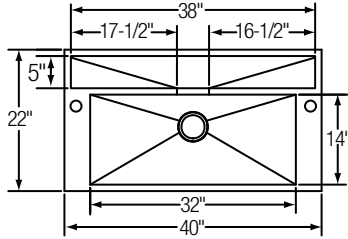

**NEW**

**EFT311811 Avado** 

Gauge: 16  
 Finish: Polished satin  
 Bowl Depth: 11"  
 Drain Opening: 3 1/2"  
 Undercoating: Sound Guard®  
 Minimum Cabinet Size: 36"

Recommended  
 Faucet: LK7420; Drain: LK99

**Optional Accessories**

- |   |   |  |
|---|---|--|
| Cutting Board  | Bottom Grid  | Drain Tray  |
| LKCB1416HW  | LKLOBG1416SS  | LKDTD1416SS  |

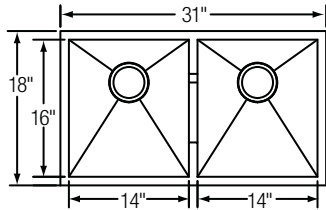



**NEW**

**EFT361111 Avado** 

Gauge: 16  
 Finish: Polished satin  
 Bowl Depth: 11"  
 Drain Opening: 3 1/2"  
 Undercoating: Sound Guard®  
 Minimum Cabinet Size: 39"

Recommended  
 Faucet: LK7422; Drain: LK99

**Optional Accessories**

- |   |  |
|---|--|
| Cutting Board  | Drain Tray  |
| LKCB1009HW  | LKDT1009SS   |

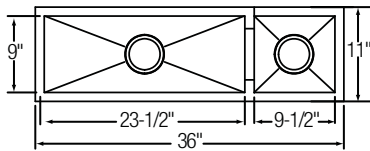

○ Indicates standard number of faucet holes /  Exclusive to Elkay Marquis Showrooms